



SEVERNE

SAILS FOR THE REVOLUTION

➤ rigging guide : C2 and no-cam sails

rigging guide : insert mast

**1a**

1. Insert the mast into the sleeve.

**1b**

rigging guide : insert mast

2. For a C2 sail, thread the mast through both cams.

2_a

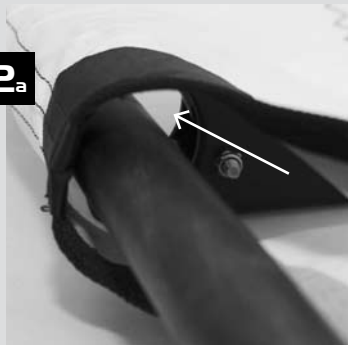

2_b

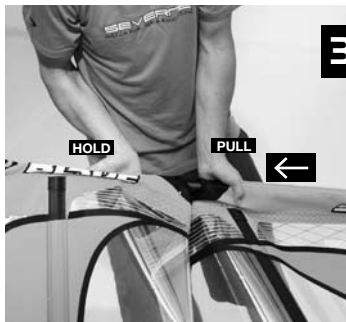

rigging guide : insert mast

**3_a**

- 3a. Work the sail down the mast by pulling sections one at a time.

NOTE: Don't ram the mast into the sleeve without pulling the sail down bit by bit. The curve in the front of the sail will make the mast jam up against the front of the sleeve, this can damage the sail.

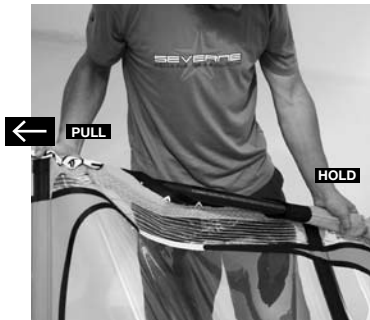

rigging guide : insert mast

3_b

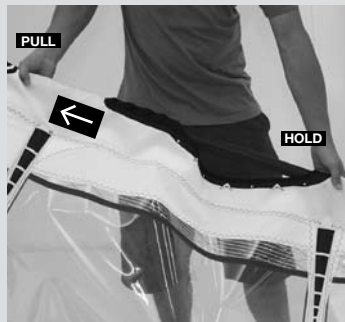
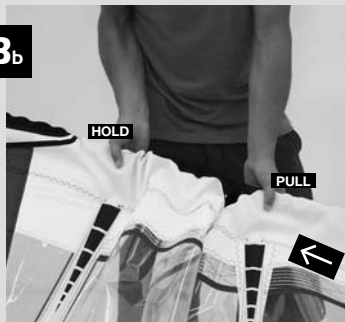

3b. On C2 sails, hold both cams and work the sail down the mast, pulling sections at a time.

4

4. Ensure the mast reaches the top of the sleeve.

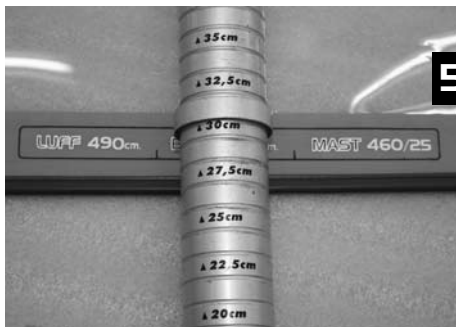

rigging guide : mast extension

5_a

5. Set the mast extension to the correct position as printed on the foot of the sail (see sail setting guide for details)

5_b

Luff 490 cm
 Mast - 460 cm
 Base = 30 cm



rigging guide : downhaul



6_a

6. Fully tension the downhaul



6_b



rigging guide : attach boom



7. Clamp the boom onto the mast.



8. Set the boom to the recommended length as printed on the foot of the sail.
(see sail setting guide for details)

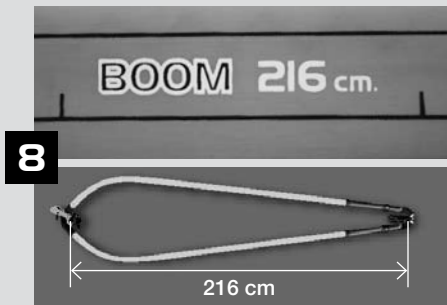

9. Outhaul the sail to the recommended setting.
(see sail setting guide for details)

rigging guide : leech twist

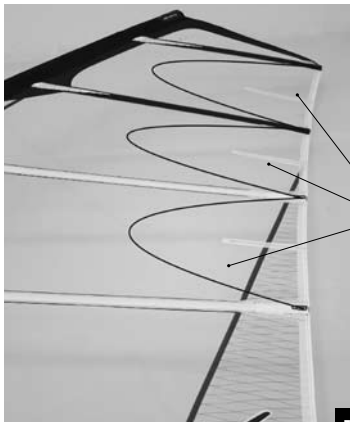

10. The correct amount of leech twist.
(see sail setting guide for details)

Loose

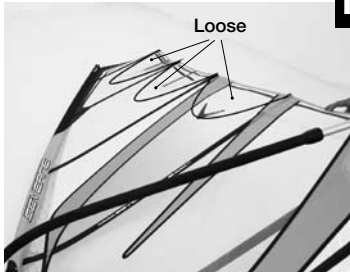

Loose

10

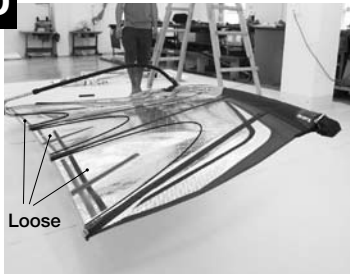

Loose

rigging guide : connect rig to board

11. Connect the sail to your board, on the C2 loop the tack strap around the mast base to hold the foot of the sail in place.

